



Professional cranes & hoists for lifting



Electric Wire Rope Hoist / AC series



TAIWAN : HOITECH MACHINERY INDUSTRIAL CO., LTD
VIETNAM : QUANG LIEN CRANE ELEVATOR CO., LTD.

AC Brake

New design of AC brake electromagnetic motor disc system works precisely and synchronously with motors, and with a rectifier for trouble free.

Control box

IP-20 control box is applied; Higher IP degree is available upon request.

Gear box

Hoist reduction gear system are made of alloy steel with surface harden treatment for long lasting life span.

MOTOR

Highly efficiently squirrel cage motors of 40%ED rate (40/20% for dual speed) are quiet, small volume, light weight and suitable for most applications.

Wire rope

According to JIS no.6 standard for wire rope applications, we use 6x37-A and IWRC 6xFl (29)-B wire rope which features flexible and long life span.

Sheave

The proper diameter of sheave ensures the operation and life span of wire rope.

Hook

Hot forged hooks with thrust bearing are enable to be swiveled 360°

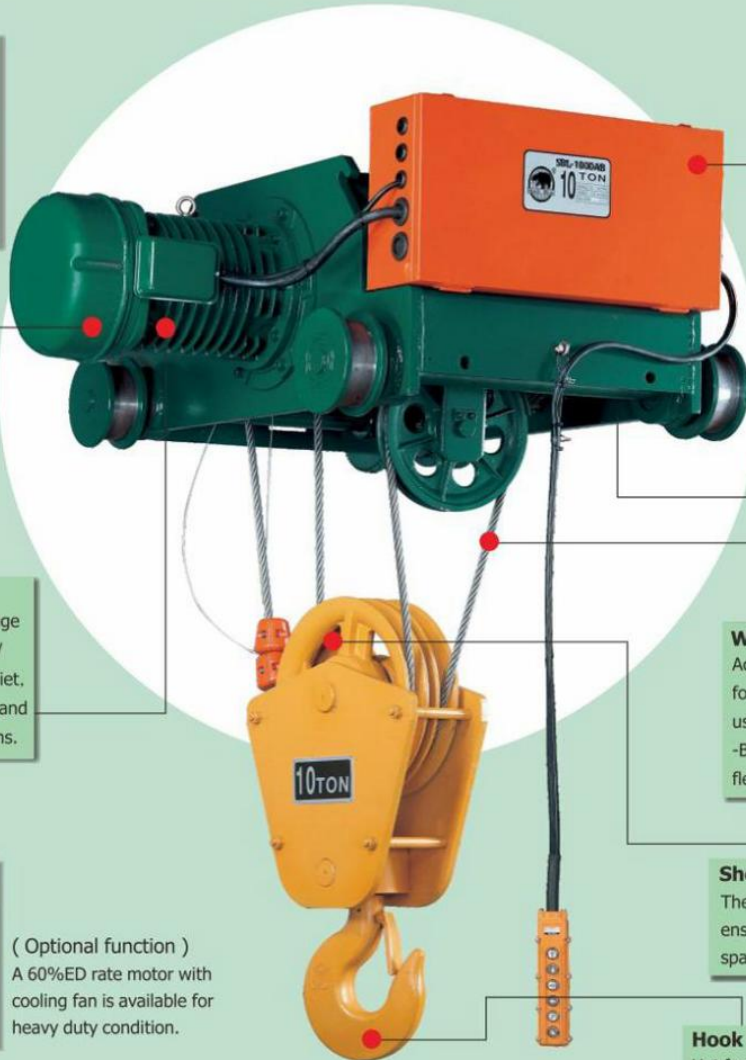

(Optional function)
A 60%ED rate motor with cooling fan is available for heavy duty condition.

PRODUCT CODE

T

Model

T : MONORAIL TROLLEY
S : SADDLE TROLLEY
F : FOOTMOUNT

B

Gear box

P : 2.2kw x 4P
K : 3kw x 4P
G : 5kw x 4P
B : 7.5~11kw x 4P
CA : 11~13kw x 4P
EA : 13kw x 4P
FA : 18.5kw x 4P

H

Reeving/Falling

N:1/1 H:2/4
M:1/2 I:2/6
L:1/4 J:2/8
P:1/6 K:2/10

D

Blank:single speed

D : Only hoist dual speed
D1 : Only trolley dual speed
D2 : Both hoist & trolley dual speed

500

S.W.L.

100 : 1ton
200 : 2ton
300 : 3ton
500 : 5ton
750 : 7.5ton
1000 : 10ton
1500 : 15ton
2000 : 20ton
3000 : 30ton

AB

AC BRAKE

SB.SCA.SEA series

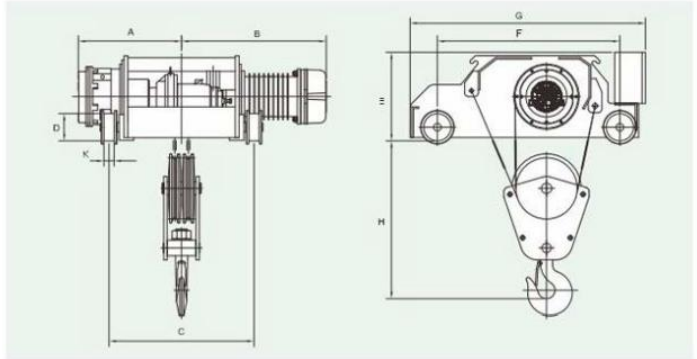

SPECIFICATIONS & DIMENSIONS :

Model	Capacity (ton)	Lift (m)	Hoisting				Traversing				Wire Rope		Approximate Dimension (mm)										Approximate Weight (kg)				
			Speed(m/min)		Motor kw pole	ED %		Speed(m/min)		Motor kw pole	ED %		mm	R/F	H	A		B		C	D	E		F	G	K	
			60Hz	50Hz		Single	Dual	60Hz	50Hz		Single	Dual				Single	Dual	Single	Dual								
SBH-500AB	5	6	7.3	6.1	7.5 4P	40	40/20	21	18	0.75 4P	40	40/20	φ 10	2/4	750	553	722	875	850	150	545	545	690	988	45	680	
SBHD-500AB		9	7.3/2.4	6.1/2.0	7.5/2.5 4/1.2P			20/6	17/6	0.25/0.25 4/1.2P						743	912	1065	1150							690	880
SBH-750AB		6	7.3	6.1	11 3P			20	17	1.1 4P						833	1092	1154	1300							790	1095
SBHD-750AB	9	7.3/2.4	6.1/2.0	11/3.7 4/1.2P	40	40/20	20/6	17/6	1.1/0.37 4/1.2P	40	40/20	φ 14	2/4	1200	608	867	929	850	160	550	550	790	1095	60	1250		
SBL-1000AB	10	6	5.0	4.2	1.1 4P	40	40/20	15	13	1.1 4P	40	40/20	φ 16	1/4	1300	605	849	911	850	160	570	570	970	1280	60	1080	
SBLD-1000AB		9	5.0/1.7	4.2/1.4	1.1/3.7 4/1.2P			15/5	13/4	1.1/0.37 4/1.2P						773	1017	1079	1150							1210	
SCAHD-1000AB		6	5.1	4.3	1.1 4P			17	14	1.1 4P						702	849	911	850							1290	
SEAL-1500AB	15	8	4.4	3.7	1.3 4P	40	40/20	18	15	1.5 4P	40	40/20	φ 20	1/4	1550	690	969	969	1150	200	715	715	1160	1500	60	1550	
SEALD-150AB		10	4.4/1.5	3.7/1.2	1.3/4.3 4/1.2P			18/6	15/5	1.5/0.5 4/1.2P						914	1061	1123	1300							1765	
SCAL-2000AB		8	3.2	2.7	1.3 4P			18	15	1.5 4P						760	969	969	1150							2000	
SCALD-2000AB	10	3.2/1.1	2.7/0.9	1.3/4.3 4/1.2P	40	40/20	18/6	15/5	1.5/0.5 4/1.2P	40	40/20	φ 20	1/4	1700	806	1014	1014	1150	200	715	715	1160	1500	60	1950		
	12														872	1080	1080	1300								2080	
																											2230

1.R/F=Reeving/falling numbers.

2. Dual speed model under green shadow.

3. Traversing pinion 5 ton M3.5x23t, 7.5 ton M3.5x20t, 10-20 ton M3.5x23t.

4. Traversing motor standard supply, 50 Hz or 60Hz all used 4 pole, or please specify.

5. Traversing motor: used reducing gear motor.

SK.SG series

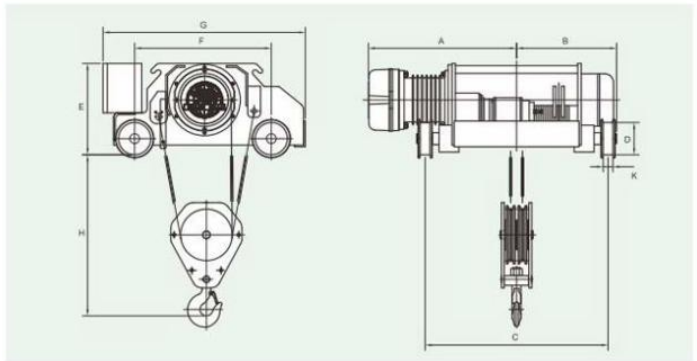

SPECIFICATIONS & DIMENSIONS :

Model	Capacity (ton)	Lift (m)	Hoisting				Traversing				Wire Rope		Approximate Dimension (mm)										Approximate Weight (kg)				
			Speed(m/min)		Motor kw pole	ED %		Speed(m/min)		Motor kw pole	ED %		mm	R/F	H	A		B	C	D	E			F	G	K	
			60Hz	50Hz		Single	Dual	60Hz	50Hz		Single	Dual				Single	Dual				Single	Dual					
SKM-200AB	2	6	8	6.7	3 4P	40	40/20	20	17	0.25 4P	40	40/20	φ 10	1/2	600	696	696	401	600	120	390	460	615	923	40	420	
SKMD-200AB		9	8/2.7	6.7/2.2	3/1 4/1.2P			20/6	17/6	0.25/0.25 4/1.2P						749	749	462	850							440	
SKH-200AB		6	8	6.7	4 4P			20	17	0.25 4P						805	805	509	850							450	
SKHD-200AB	9	8/2.7	6.7/2.2	3/1 4/1.2P	40	40/20	20/6	17/6	0.25/0.25 4/1.2P	40	40/20	φ 8	2/4	600	891	891	612	1150	120	390	460	615	923	40	470		
SKL-300AB	3	6	4.4	3.7	0.4 4P	40	40/20	21	18	0.4 4P	40	40/20	φ 10	1/4	650	746	746	465	850	150	425	495	725	1030	45	490	
SKLD-300AB		9	4.4/1.5	3.7/1.2	0.4/1.2P			21/7	18/6	0.4/0.3 4/1.2P						818	818	523	850							500	
SGM-300AB		12																									
SGMD-300AB	6	8	6.7	5 4P	21	18	0.4 4P	693	763	477	850	490															
SGH-300AB	9	8/2.7	6.7/2.2	3/1 4/1.2P	40	40/20	21/7	18/6	0.4/0.3 4/1.2P	40	40/20	φ 12	1/2	750	693	763	477	850	150	495	495	660	968	45	500		
SGHD-300AB	6	8	6.7	5 4P	21	18	0.4 4P	796	867	579	850	510															
SGL-500AB	5	6	4.4	3.7	0.4 4P	40	40/20	21	18	0.75 4P	40	40/20	φ 10	2/4	750	746	816	529	850	150	495	495	635	940	45	520	
SGLD-500AB		9	4.4/1.5	3.7/1.2	0.4/1.2P			21/7	18/6	0.4/0.3 4/1.2P						818	888	602	850							580	
		12																									
																746	816	529	850								570
																818	888	602	850								590
																965	1035	749	1150								630

1.R/F=Reeving/falling numbers.

2. Dual speed model under green shadow.

3. Traversing pinion 2 ton M3.5x15t, 3-5 ton, M3.5x23t.

4. Traversing motor standard supply, 50 Hz or 60Hz all used 4 pole, or please specify.

5. Traversing motor: 2 ton used planetary reducing gear motor, 3-5 ton used reducing gear motor.

SFA series

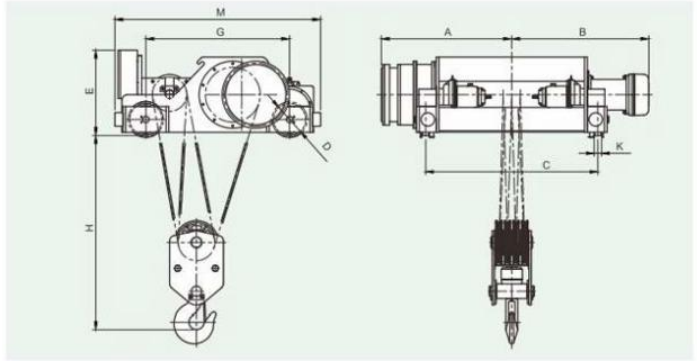

SPECIFICATIONS & DIMENSIONS :

Model	Capacity (ton)	Lift (m)	Hoisting				Traversing				Approximate Dimension (mm)										Approximate Weight (kg)							
			Speed (m/min)		Motor kw pole	ED %	Speed (m/min)		Motor kw pole	ED %	Wire Rope		H	A	B		C	D	E	G		K	M					
			60Hz	50Hz			60Hz	50Hz			Single	Dual			φ mm	R/F								Single	Dual			
SFAH-1500AB	15	8	6.1	5.1	18.5 4P	40	40/20	18	15	1.5 4P	40	40/20	φ 18	2/4	1600	1007	1069	1187	1150	200	725	1150	60	1475	2115			
SFAHD-1500AB		10	6.1/2.0	5.1/1.7	18.5/6.2 4/12P											18/6	15/5	1.5/0.5 4/12P	1093						1155	1273	1400	2528
SFAJ-3000AB		12	3.0	2.5	18.5 4P											21	17.5	1.5 2P	1113						1175	1293	1400	2500
SFAJD-3000AB	30	10	3.0/1.0	2.5/0.8	18.5/6.2 4/12P	40	40/20	21/7	17.5/5.8	1.5/0.5 2P	40	40/20	φ 18	2/8	1800	1213	1275	1393	1600	300	730	1336	70	1936	2725			
		12	3.0	2.5	18.5 4P											21/7	17.5/5.8	1.5/0.5 2P	1313						1375	1493	1800	2950

1.R/F=Reeving/falling numbers.

2. Dual speed model under green shadow.

3. Traversing pinion M4x18t.

4. Traversing motor standard supply, 50 Hz or 60Hz all used 4 pole, or please specify.

5. Traversing motor: used reducing gear motor.

FP.FK.FG.FB series

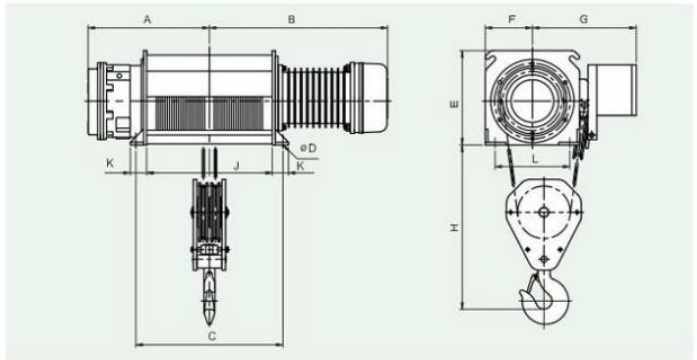

SPECIFICATIONS & DIMENSIONS :

Model	Capacity (ton)	Lift (m)	Hoisting				Wire Rope		Approximate Dimension (mm)													Approximate Weight (kg)
			Speed (m/min)		Motor kw pole	ED %	φ mm	R/F	H	A	B	C	D	E	F	G	J	K	L			
			60Hz	50Hz																		
FPM-100AB	1	6	10.8	9	2.2 4P	40	φ 8	1/2	650	314	557	467	φ 16	322	150	450	353	82	280	205		
		9								364	607	567					453					
		12								414	657	567					553					
		15								480	724	800					686					
		6								348	644	466					352					
FKM-200AB	2	9	8	6.7	3 4P	40	φ 10	1/2	1150	401	696	571	φ 16	402	232	420	457	82	260	339		
		12								453	749	676					562					
		15								505	801	780					666					
		6								422	718	614					500					
		9								509	805	788					674					
FKH-200AB	2	9	8	6.7	3 4P	40	φ 8	2/4	1150	596	891	961	φ 16	390	232	433	847	72	260	439		
		12								693	988	1155					1041					
		15								693	988	1155					1041					
		6								435	652	482					368					
		9								477	693	565					451					
FGM-300AB	3	9	8	6.7	5 4P	40	φ 12	1/2	1250	579	796	770	φ 16	442	185	430	656	82	280	370		
		12								633	850	878					764					
		15								450	746	670					556					
		6								523	818	815					701					
		9								675	970	1119					1005					
FKL-300AB	3	9	4.4	3.7	3 4P	40	φ 10	1/4	1100	814	1110	1398	φ 16	372	275	443	1284	82	310	430		
		12								529	746	670					556					
		15								602	818	815					701					
		6								529	746	670					556					
		9								602	818	815					701					
FGH-300AB	3	9	8	6.7	5 4P	40	φ 10	2/4	1250	719	935	1049	φ 16	430	185	443	935	74	280	395		
		12								814	1030	1239					1125					
		15								814	1030	1239					1125					
		6								529	746	670					556					
		9								602	818	815					701					
FGL-500AB	5	9	4.4	3.7	5 4P	40	φ 10	1/4	1100	749	965	1109	φ 16	442	285	453	995	82	330	490		
		12								859	1075	1329					1215					
		15								859	1075	1329					1215					
		6								553	726	670					556					
		9								603	776	770					656					
FBH-500AB	5	9	7.3	6.1	7.5 4P	40	φ 10	2/4	1300	743	915	1049	φ 16	440	215	483	935	74	350	603		
		12								818	991	1200					1086					
		15								818	991	1200					1086					
		6								553	726	670					556					
		9								603	776	770					656					

1.R/F=Reeving/falling numbers.

TP.TK.TG series

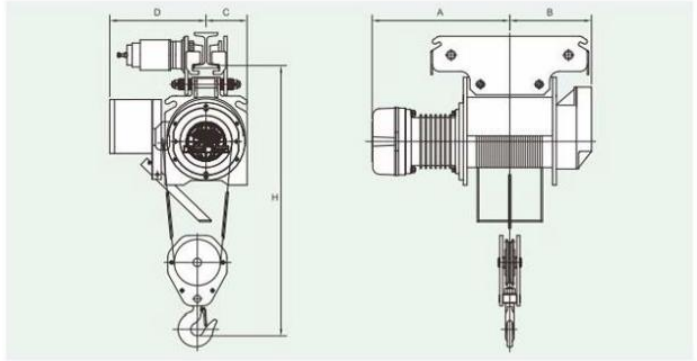

SPECIFICATIONS & DIMENSIONS :

Model	Capacity (ton)	Lift (m)	Hoisting				Traversing				Wire Rope		Approximate Dimension (mm)						Adjust for Std. I-Beam (mm)	Approximate Weight (kg)					
			Speed(m/min)		Motor kw pole	ED %		Speed(m/min)		Motor kw pole	ED %		H	A		B		C			D				
			60Hz	50Hz		Single	Dual	60Hz	50Hz		Single	Dual		φ mm	R/F	Single	Dual	Single			Dual	Single	Dual	Single	Dual
TPM-100AB	1	6	10.8	9	2.2 4P	40	40/20	24	20	0.25 4P	40	40/20	φ 8	1/2	1050	557	638	314	210	210	380	380	75-125	246	
TPMD-100AB		9	10.8/36	9/3	2.2/0.73 4/1.2P	40	40/20	24/8	20/6	0.25/0.08 4/1.2P	40	40/20	φ 8	1/2	1050	607	688	364	210	210	380	380	75-125	256	
TKM-200AB		6	8	6.7	4P	40	40/20	24	20	0.25 4P	40	40/20	φ 10	1/2	1150	644	644	350	266	266	401	401	100-150	370	
TKMD-200AB	2	6	8/2.7	6.7/2.2	3/1 4/1.2P	40	40/20	24/8	20/6	0.25/0.08 4/1.2P	40	40/20	φ 10	1/2	1150	696	696	403	266	266	401	401	100-150	390	
TKH-200AB		9	8	6.7	4P	40	40/20	24	20	0.25 4P	40	40/20	φ 8	2/4	1150	749	749	455	262	262	403	403	100-150	410	
TKHD-200AB		12	8/2.7	6.7/2.2	3/1 4/1.2P	40	40/20	24/8	20/6	0.25/0.08 4/1.2P	40	40/20	φ 8	2/4	1150	718	718	422	262	262	403	403	100-150	400	
TKL-300AB	3	6	4.4	3.7	3 4P	40	40/20	18	15	0.6 4P	40	40/20	φ 10	1/4	1150	746	746	518	275	275	443	443	125-175	420	
TKLD-300AB		9	4.4/1.5	3.7/1.2	3/1 4/1.2P	40	40/20	18/6	15/5	0.6/0.2 4/1.2P	40	40/20	φ 10	1/4	1150	818	818	523	275	275	443	443	125-175	440	
TGM-300AB		12	4.4/1.5	3.7/1.2	3/1 4/1.2P	40	40/20	18/6	15/5	0.6/0.2 4/1.2P	40	40/20	φ 10	1/4	1150	970	970	675	275	275	443	443	125-175	410	
TGMD-300AB	3	6	8	6.7	5 4P	40	40/20	18	15	0.6 4P	40	40/20	φ 12	1/2	1200	652	722	435	207	245	442	442	125-175	430	
TGH-300AB		9	8	6.7	5 4P	40	40/20	18	15	0.6 4P	40	40/20	φ 10	1/2	1200	693	763	477	207	245	442	442	125-175	450	
TGHD-300AB		12	8/2.7	6.7/2.2	5/1.7 4/1.2P	40	40/20	18/6	15/5	0.6/0.2 4/1.2P	40	40/20	φ 10	2/4	1200	796	866	579	207	245	442	442	125-175	450	
TGL-500AB	5	6	8	6.7	5 4P	40	40/20	18	15	0.6 4P	40	40/20	φ 10	1/4	1200	746	816	529	300	300	468	468	125-175	390	
TGLD-500AB		9	4.4	3.7	5 4P	40	40/20	18	15	0.6 4P	40	40/20	φ 10	1/4	1200	818	888	602	300	300	468	468	125-175	425	
TGLD-500AB		12	4.4/1.5	3.7/1.2	5/1.7 4/1.2P	40	40/20	18/6	15/5	0.6/0.2 4/1.2P	40	40/20	φ 10	1/4	1200	935	1005	719	300	300	468	468	125-175	455	

1.R/F=Reeving/falling numbers.

2.Dual speed model under green shadow.

3.Traversing pinion 2 ton M3.5x16t, 3-5 ton M3.5x12t.

4.Traversing motor standard supply, 50 Hz or 60Hz all used 4 pole, or please specify.

TB series

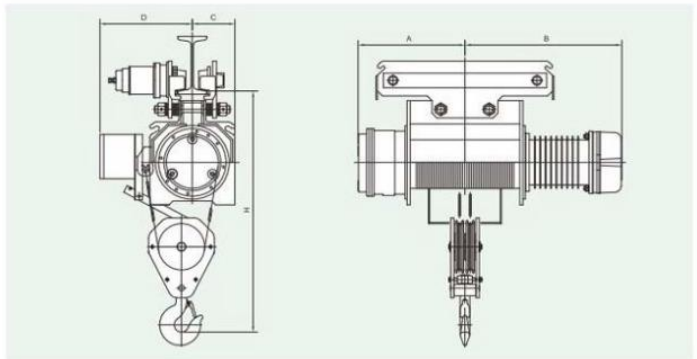

SPECIFICATIONS & DIMENSIONS :

Model	Capacity (ton)	Lift (m)	Hoisting				Traversing				Wire Rope		Approximate Dimension (mm)						Adjust for Std. I-Beam (mm)	Approximate Weight (kg)					
			Speed(m/min)		Motor kw pole	ED %		Speed(m/min)		Motor kw pole	ED %		H	A		B		C			D				
			60Hz	50Hz		Single	Dual	60Hz	50Hz		Single	Dual		φ mm	R/F	Single	Dual	Single			Dual	Single	Dual	Single	Dual
TBH-500AB	5	6	7.3	6.1	7.5 4P	40	40/20	18	15	1.1 4P	40	40/20	φ 10	2/4	1250	553	726	870	278	315	445	453	125-175	590	
TBHD-500AB		9	7.3/2.4	6.1/2.0	7.5/2.5 4/1.2P	40	40/20	18/6	15/5	1.1/0.37 4/1.2P	40	40/20	φ 10	2/4	1250	603	776	920	278	315	445	453	125-175	630	
TBH-750AB		6	7.3	6.1	11 4P	40	40/20	20	17	1.1 4P	40	40/20	φ 14	2/4	2000	743	915	1059	294	294	642	642	150-200	990	
TBHD-750AB	7.5	6	7.3/2.4	6.1/2.0	11/3.7 4/1.2P	40	40/20	20/6	17/6	1.1/0.37 4/1.2P	40	40/20	φ 14	2/4	2000	743	1005	1059	294	294	642	642	150-200	1020	
TBL-1000AB		9	5.0	4.2	11 4P	40	40/20	18	15	1.1 4P	40	40/20	φ 16	1/4	2000	605	853	907	380	380	640	725	150-200	970	
TBLD-1000AB		12	5.0/1.7	4.2/1.4	11/3.7 4/1.2P	40	40/20	18/6	15/5	1.1/0.37 4/1.2P	40	40/20	φ 16	1/4	2000	673	921	975	380	380	640	725	150-200	1000	

1.R/F=Reeving/falling numbers.

2.Dual speed model under green shadow.

3.Traversing pinion 5 ton M3.5x12t, 7.5 ton M3.5x20t, 10 ton M3.5x23t.

4.Traversing motor standard supply, 50 Hz or 60Hz all used 4 pole, or please specify.

5.Traversing motor: 5 ton used planetary reducing gear motor, 7-10 ton used reducing gear motor.

PRODUCT GUIDE

Capacity (ton)	Monorail High Speed	Crab High Speed	Footmount High Speed	Monorail Low Speed	Crab Low Speed	Footmount Low Speed	Dual Speed
1	TPM-100AB		FPM-100AB				TPMD-100AB
2	TKM-200AB	SKM-200AB	FKM-200AB				TKMD-200AB SKMD-200AB
2	TKH-200AB	SKH-200AB	FKH-200AB				TKHD-200AB SKHD-200AB
3	TGM-300AB	SGM-300AB	FGM-300AB	TKL-300AB	SKL-300AB	FKL-300AB	TGMD-300AB SGMD-300AB TKLD-300AB SKLD-300AB
3	TGH-300AB	SGH-300AB	FGH-300AB				TGHD-300AB SGHD-300AB
5	TBH-500AB	SBH-500AB	FBH-500AB	TGL-500AB	SGL-500AB	FGL-500AB	TBHD-500AB SBHD-500AB TGLD-500AB SGLD-500AB
7.5	TBH-750AB	SBH-750AB					TBHD-750AB SBHD-750AB
10		SCAH-1000AB		TBL-1000AB	SBL-1000AB		SCAHD-1000AB SBLD-1000AB TBLD-1000AB
15		SFAH-1500AB			SEAL-1500AB		SEALD-1500AB SFAHD-1500AB
20					SCAL-2000AB		SCALD-2000AB
30					SFAJ-3000AB		SFAJD-3000AB

WIRE ROPE



Rope Dia (mm) d	Mode Being Used	Construction	Specified Breaking Load (kn)
ø 8	TPM-100AB FPM-100AB TKH-200AB SKH-200AB FKH-200AB	6x37-A	34
	TKL-300AB SKL-300AB FKL-300AB TGH-300AB SGH-300AB FGH-300AB		53.1
ø 10	TKM-200AB SKM-200AB FKM-200AB	IWRC 6xFi(29)-B	67.7
	TGL-500AB SGL-500AB FGL-500AB TBH-500AB SBH-500AB FBH-500AB	IWRC 6xP.Fi(29)-H	84
ø 12	TGM-300AB SGM-300AB FGM-300AB	IWRC 6xFi(29)-B	97.7
ø 14	TBH-750AB SBH-750AB	6x37-H	123
ø 16	TBL-1000AB SBL-1000AB SCAH-1000AB	6x37-H	161
ø 18	SFAH-1500AB SFAJ-3000AB	IWRC 6xFi(29)-H	234
	SEAL-1500AB		289
ø 20	SCAL-2000AB	IWRC 6xP.Fi(29)-H	331

HOOK

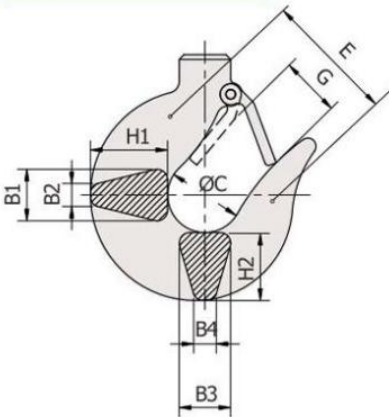

Mode	Capacity (ton)	Dimension (mm)									Allow Stress (kg/mm ²)	Hook Block Weight (kg)
		H1	B1	B2	H2	B3	B4	C	G	E		
T;FPM	1	33	23	9	29	23	9	40	27	55	70	10
T;F;SKM	2	45	31	10	41	31	10	45	33	70	70	30
T;F;SKH												
T;F;SGM	3(2.8)	57	38	12	52	38	12	60	42	100	70	40
T;F;SKL												
T;F;SGH												50
T;F;SGL	5	75	48	16	68	48	16	75	56	105	70	50
T;F;SBH												60
T;SBH	7.5	85	61	22	77	61	22	85	62	140	70	90
T;SBL	10	100	70	28	95	65	28	100	70	130	70	150
SCAH												140
SEAL	15	120	85	32	110	83	32	120	82	167	70	220
SFAH												
SCAL	20	140	100	38	130	95	38	140	105	220	70	290
SFAJ	30	140	98	38	130	94	38	140	105	220	100	420



POWER SUPPLY :

- ▲ Electric wire rope hoist suits majority of the 3-Phase power in different countries, available in 50Hz or 60Hz, voltage from 220V up to 600V.
- ▲ Dual-volt hoist subject to our confirmation.

LIFTING HEIGHT :

- ▲ Standard lifting height : Please refer to specifications.
- ▲ Optional height available upon request.

PUSH BUTTON SWITCH :

- ▲ 2-point type : up and down.
- ▲ 4-point type : up and down : left and right (trolley).
- ▲ 6-point type : up and down : left and right : forward and reverse (end carrier)

FEDERATION EUROPEENNE DE LA MANUTENTION

Load spectrum	Cubic mean value Definitions	Average operating time per day in hours							
1 (light)	($k \leq 0.50$) Mechanisms or parts thereof, usually subject to very small loads and in exceptional cases only to maximum loads.	0.25-0.5	0.5-1	1-2	2-4	4-8	8-16	> 16	
2 (medium)	($0.50 < k \leq 0.63$) Mechanisms or parts thereof, usually subject to small loads but rather often to maximum loads.	0.12-0.25	0.25-0.5	0.5-1	1-2	2-4	4-8	8-16	> 16
3 (heavy)	($0.63 < k \leq 0.80$) Mechanisms or parts thereof, usually subject to medium loads but frequently to maximum loads.	≤ 0.12	0.12-0.25	0.25-0.5	0.5-1	1-2	2-4	4-8	8-16
4 (very heavy)	($0.80 < k \leq 1$) Mechanisms or parts thereof, usually subject to maximum or almost to maximum loads.		≤ 0.12	0.12-0.25	0.25-0.5	0.5-1	1-2	2-4	4-8
Classification of Mechanisms FEM 9.511		1 Dm	1 Cm	1 Bm	1 Am	2 m	3 m	4 m	5 m

ISO/FEM (9.511)

Classification of mechanisms:

1 Dm	1 Cm	1 Bm	1 Am	2 m	3 m	4 m	5 m
M 1	M 2	M 3	M 4	M 5	M 6	M 7	M 8

Class of operating time:

Class of operation time	Average operating time per day (in hours)	Calculated total operating time in hours
V0.06 T0	≤ 0.12	200
V0.12 T1	≤ 0.25	400
V0.25 T2	≤ 0.5	800
V0.5 T3	≤ 1	1600
V1 T4	≤ 2	3200
V2 T5	≤ 4	6300
V3 T6	≤ 8	12500
V4 T7	≤ 16	25000
V5 T8	> 16	50000

Classification of mechanisms into groups:

Load spectrum	Cubic mean value	Class of operation time									
		V0.06	V0.12	V0.25	V0.5	V1	V2	V3	V4	V5	
		T0	T1	T2	T3	T4	T5	T6	T7	T8	
		Average operating time per day in hours									
		≤ 0.12	≤ 0.25	≤ 0.5	≤ 1	≤ 2	≤ 4	≤ 8	≤ 16	> 16	
1	L1	$k \leq 0.50$			1 Dm	1 Cm	1 Bm	1 Am	2 m	3 m	4 m
2	L2	$0.50 < k \leq 0.63$		1 Dm	1 Cm	1 Bm	1 Am	2 m	3 m	4 m	5 m
3	L3	$0.63 < k \leq 0.80$	1 Dm	1 Cm	1 Bm	1 Am	2 m	3 m	4 m	5 m	
4	L4	$0.80 < k \leq 1.00$	1 Cm	1 Bm	1 Am	2 m	3 m	4 m	5 m		

OPERATION CYCLE

Hoist with one speed



Hoist with two speed

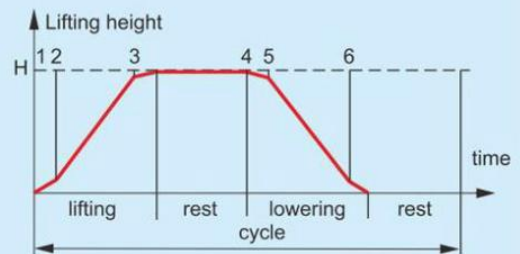

Professional cranes & hoists for lifting



Taiwan Black Bear Factory



QUANG LIEN Factory



TAIWAN : HOITECH MACHINERY INDUSTRIAL CO., LTD

ADD : No.126, Lane 332, Sec.8, HuanJhong Rd., Wu-Zih, Taichung, Taiwan, R.O.C
TEL : +886-4-2335 3333 FAX : +886-4-2335 3031
E-mail : hoitech2222@gmail.com



VIETNAM : QUANG LIEN CRANE ELEVATOR CO., LTD.

ADD : 299/15^A Ly Thuong Kiet, P.15 - Q.11 - TP.HCM
TEL : +84-8-3863 6666 FAX : +84-8-3864 7212
E-mail : quangliencrane@hcm.vnn.vn
WEB : www.quanglien.com

